

Standard Exhibit Systems

With the following GES® standard exhibits to choose from, selecting the size and configuration that meets your tradeshow needs is easy. Our modular exhibits are hassle-free because you pay no design fees, no shipping fees, and no repair or refurbishing fees. Plus, you may customize the trim and panels, and choose from a wide variety of accessories to create a unique exhibit that reinforces your brand and marketing efforts.

All packages include rental, delivery, installation, and dismantling. For other custom furnishings, hanging signs, or graphics, chat with your GES National Servicer® representative at www.ges.com/chat.

20x20 Exhibits

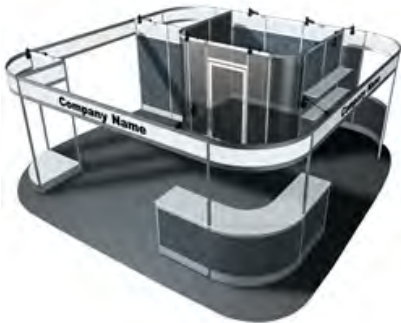

600005 - Exhibit System GEM #5, 20'x20' Island Includes:

- three digitally printed signs
- one locking office
- four shelves
- one curved counter
- two 1m counters
- ten arm lights
- one standard 20' x 20' carpet
- no padding

10x20 Exhibits

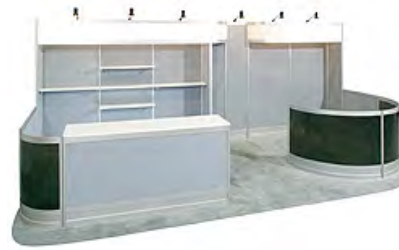

600004 - Exhibit System GEM #4, 10'x20' Inline Includes:

- one 117" x 12" digitally printed sign
- one 57-7/8" x 12" digitally printed sign
- one 2m counter
- six arm lights
- five shelves
- one standard 10' x 20' carpet
- no padding

10x10 Exhibits



600002 - Exhibit System GEM #2, 10'x10' Inline Includes:

- one custom ID sign
- two arm lights
- one standard 10' x 10' carpet
- no padding



600003 - Exhibit System GEM #3, 10'x10' Inline Includes:

- one custom ID sign
- three arm lights
- five shelves
- one 1m counter
- one standard 10' x 10' carpet
- no padding

6ft Table Display



600001 - Exhibit System GEM #1, 6' Tabletop Display Includes:

- one custom ID sign
- three arm lights
- two shelves
- one 6' skirted table
- no carpet and padding

Please note that although arm lights may be included in your package, electrical power must be ordered separately through the electrical services provider in your exhibitor service manual. Colors may vary due to facility lighting, printing limitations and dye lot differences.

Standard Exhibit Systems

Accessories



600410 - Exhibit, Ad Board, 1M x 8'



600110 - Exhibit, Armlight Black



600103 - Exhibit, Counter, 1M Curved



600101 - Exhibit, Counter, 1M x 1/2M x 40"H



600102 - Exhibit, Counter, 2M x 1/2M x 40"H



600221 - Exhibit, Light Box, Large 37"x85"



600222 - Exhibit, Light Box, Medium 37"x56"



600223 - Exhibit, Light Box, Small 37"x28"



661931 - Exhibit, Panel, Slatwall, 1M x 8'

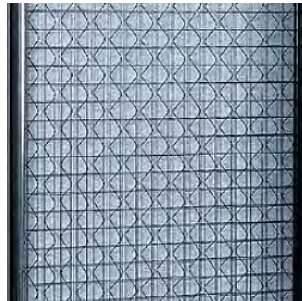

600291 - Exhibit, Panel, Wirewall, 1M



600243 - Exhibit, Shelf, 1M x 10" Deep

Trim and Panel Choices

Panel Type & Color

Coated: Black (C41)

Coated: Oxford White (C50)

Coated: Silver Gray (C79)

Fabric: Black (F41)

Fabric: Gray (F40)

Trim Color

Black (41)

Silver (79)

Please note that although arm lights may be included in your package, electrical power must be ordered separately through the electrical services provider in your exhibitor service manual. Colors may vary due to facility lighting, printing limitations and dye lot differences.

Standard Exhibits Graphics

Exhibit #1, 6' Tabletop (600001)

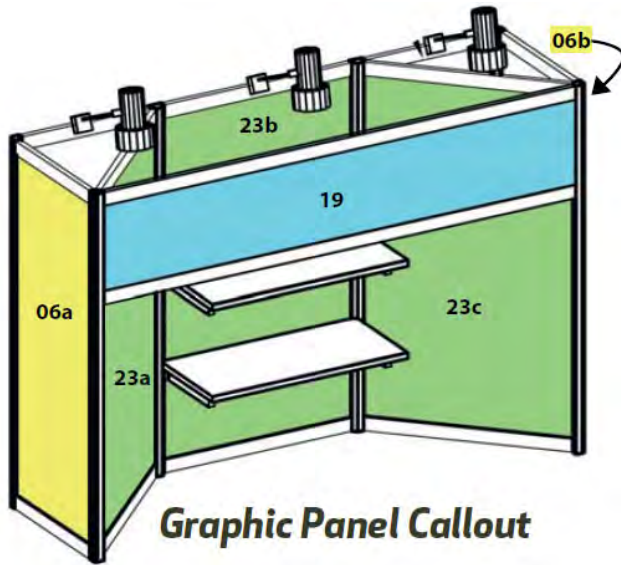

Graphic Panel Callout

- 23** 608323 26 9/16" wide x 45" tall
Discount Price - \$174.75 /Regular Price - \$262.50
Produced on 3/16" Thick White Foamcore
- 06** 608306 18 7/16" wide x 45" tall
Discount Price - \$72.50 /Regular Price - \$109.00
Produced on 3/16" Thick White Foamcore
- 19** 608319 65 15/16" wide x 12" tall
Discount Price - \$116.00 /Regular Price - \$173.75
Produced on 3/16" Thick White Foamcore

All Prices listed above are Per Panel.

Please note that pricing listed is for Graphic Panels only. GEM units are rented separately.

GES requires a form of payment for booth graphics in order to produce signage. Please see Payment and Credit Card Authorization (G-2) for required information.

Please contact GES National Service Center at 800-475-2098 or 702-515-5970 with any questions or concerns.

Link: <https://e.ges.com/011601558/exhibit1/esm>



Booth Rendering

Please note that although arm lights may be included in your package, electrical power must be ordered separately through the electrical services provider in your exhibitor service manual. Colors may vary due to facility lighting, printing limitations and dye lot differences.

Standard Exhibits Graphics

Exhibit #2, 10 x 10 (600002)

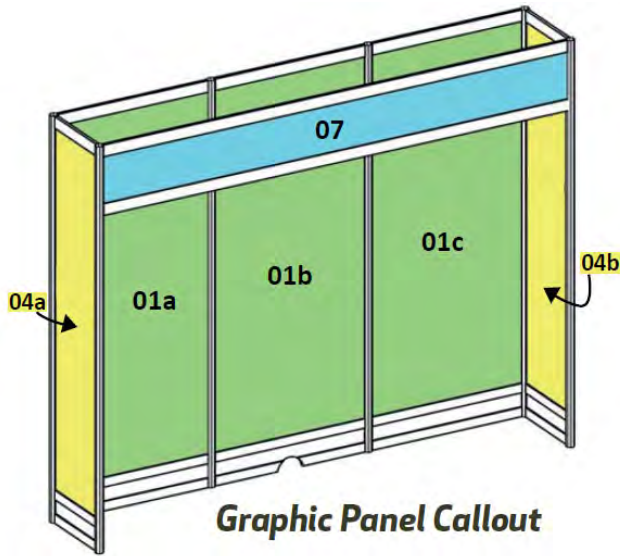

- 01** 608301 38 1/8" wide x 86 1/4" tall
 Discount Price - \$479.75 /Regular Price - \$720.00
 Produced on 3/16" Thick White Foamcore
- 04** 608304 18 7/16" wide x 86 1/4" tall
 Discount Price - \$241.50 /Regular Price - \$362.75
 Produced on 3/16" Thick White Foamcore
- 07** 608307 117" wide x 12" tall
 Discount Price - \$205.50 /Regular Price - \$308.25
 Produced on 3/16" Thick White Foamcore

All Prices listed above are Per Panel.

Please note that pricing listed is for Graphic Panels only. GEM units are rented separately.

GES requires a form of payment for booth graphics in order to produce signage. Please see Payment and Credit Card Authorization (G-2) for required information.

Please contact GES National Service Center at 800-475-2098 or 702-515-5970 with any questions or concerns.

Link: <https://e.ges.com/011601558/exhibit2/esm>



Booth Rendering

Please note that although arm lights may be included in your package, electrical power must be ordered separately through the electrical services provider in your exhibitor service manual. Colors may vary due to facility lighting, printing limitations and dye lot differences.

Standard Exhibits Graphics

Exhibit #3, 10 x 10 (600003)

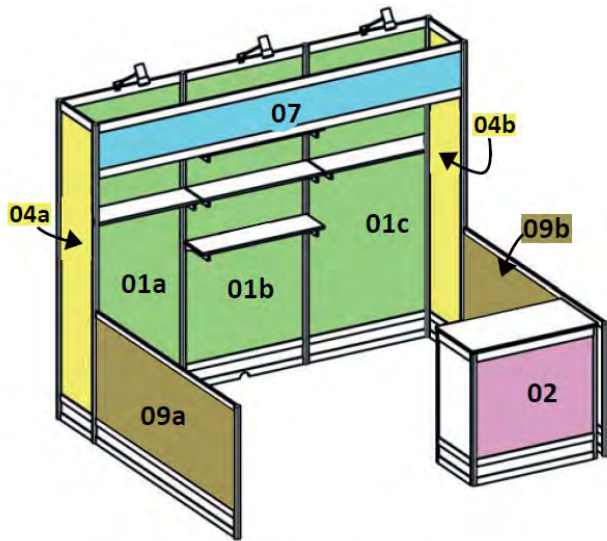

Graphic Panel Callout

- 01** 608301 38 1/8" wide x 86 1/4" tall
 Discount Price - \$479.75 /Regular Price - \$720.00
 Produced on 3/16" Thick White Foamcore
- 04** 608304 18 7/16" wide x 86 1/4" tall
 Discount Price - \$241.50 /Regular Price - \$362.75
 Produced on 3/16" Thick White Foamcore
- 07** 608307 117" wide x 12" tall
 Discount Price - \$205.50 /Regular Price - \$308.25
 Produced on 3/16" Thick White Foamcore
- 02** 608302 38 1/8" wide x 30 1/4" tall
 Discount Price - \$168.25 /Regular Price - \$252.50
 Produced on 3/16" Thick White Foamcore
- 09** 608309 77 1/2" wide x 30 1/4" tall
 Discount Price - \$343.25 /Regular Price - \$514.75
 Produced on 3/16" Thick White Foamcore

All Prices listed above are Per Panel.

Please note that pricing listed is for Graphic Panels only. GEM units are rented separately.

GES requires a form of payment for booth graphics in order to produce signage. Please see Payment and Credit Card Authorization (G-2) for required information.

Please contact GES National Service Center at 800-475-2098 or 702-515-5970 with any questions or concerns.

Link: <https://e.ges.com/011601558/exhibit3/esm>



Booth Rendering

Please note that although arm lights may be included in your package, electrical power must be ordered separately through the electrical services provider in your exhibitor service manual. Colors may vary due to facility lighting, printing limitations and dye lot differences.

Standard Exhibits Graphics

Exhibit #4, 10 x 20 (600004)

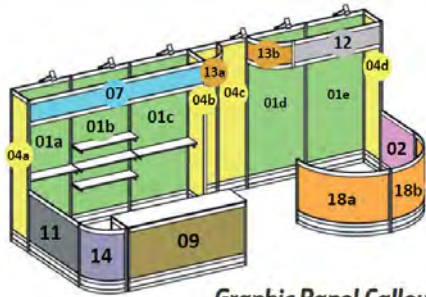

Graphic Panel Callout

- 12** 608312 57 7/8" wide x 12" tall
Discount Price - \$105.50 /Regular Price - \$158.25
Produced on 3/16" Thick White Foamcore
- 13** 608313 29 3/4" wide x 12" tall
Discount Price - \$52.75 /Regular Price - \$79.25
Produced on 1/8" Thick White Foamacell
- 18** 608318 60 3/4" wide x 30 1/4" tall
Discount Price - \$268.75 /Regular Price - \$403.25
Produced on 1/8" Thick White Foamacell
- 09** 608309 77 1/2" wide x 30 1/4" tall
Discount Price - \$343.25 /Regular Price - \$514.75
Produced on 3/16" Thick White Foamcore
- 14** 608314 29 3/4" wide x 30 1/4" tall
Discount Price - \$131.00 /Regular Price - \$196.75
Produced on 1/8" Thick White Foamacell

- 01** 608301 38 1/8" wide x 86 1/4" tall
Discount Price - \$479.75 /Regular Price - \$720.00
Produced on 3/16" Thick White Foamcore
- 04** 608304 18 7/16" wide x 86 1/4" tall
Discount Price - \$241.50 /Regular Price - \$362.75
Produced on 3/16" Thick White Foamcore
- 11** 608311 57 7/8" wide x 30 1/4" tall
Discount Price - \$101.25 /Regular Price - \$152.00
Produced on 3/16" Thick White Foamcore
- 02** 608302 38 1/8" wide x 30 1/4" tall
Discount Price - \$168.25 /Regular Price - \$252.50
Produced on 3/16" Thick White Foamcore
- 07** 608307 117" wide x 12" tall
Discount Price - \$205.50 /Regular Price - \$308.25
Produced on 3/16" Thick White Foamcore



Booth Rendering

All Prices listed above are Per Panel.

Please note that pricing listed is for Graphic Panels only. GEM units are rented separately.

GES requires a form of payment for booth graphics in order to produce signage. Please see Payment and Credit Card Authorization (G-2) for required information.

Please contact GES National Service Center at 800-475-2098 or 702-515-5970 with any questions or concerns.

Link: <https://e.ges.com/011601558/exhibit4/esm>

Please note that although arm lights may be included in your package, electrical power must be ordered separately through the electrical services provider in your exhibitor service manual. Colors may vary due to facility lighting, printing limitations and dye lot differences.

Standard Exhibits Graphics

Exhibit #5, 20 x 20 (600005)

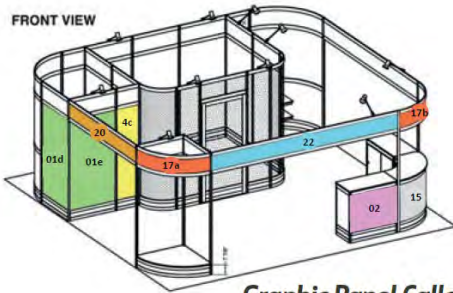

Graphic Panel Callout

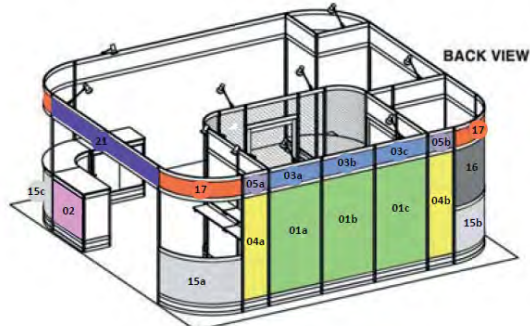

- 21** 608321 136 9/16" wide x 12" tall
Discount Price - \$158.25 /Regular Price - \$238.25
Produced on 3/16" Thick White Foamcore
- 20** 608320 97 3/16" wide x 12" tall
Discount Price - \$169.50 /Regular Price - \$254.75
Produced on 1/8" Thick White Foamcore
- 17** 608317 60 11/16" wide x 12" tall
Discount Price - \$196.75 /Regular Price - \$294.75
Produced on 1/8" Thick White Foamacell
- 02** 608302 38 1/8" wide x 30 1/4" tall
Discount Price - \$168.25 /Regular Price - \$252.50
Produced on 3/16" Thick White Foamcore
- 03** 608303 38 1/8" wide x 12" tall
Discount Price - \$67.25 /Regular Price - \$100.75
Produced on 3/16" Thick White Foamcore
- 05** 608305 18 7/16" wide x 12" tall
Discount Price - \$52.75 /Regular Price - \$79.25
Produced on 3/16" Thick White Foamcore

- 01** 608301 18 7/16" wide x 86 1/4" tall
Discount Price - \$479.75 /Regular Price - \$720.00
Produced on 3/16" Thick White Foamcore
- 04** 608304 18 7/16" wide x 86 1/4" tall
Discount Price - \$241.50 /Regular Price - \$362.75
Produced on 3/16" Thick White Foamcore
- 16** 608316 60 11/16" wide x 40 1/4" tall
Discount Price - \$321.00 /Regular Price - \$482.00
Produced on 1/8" Thick White Foamacell
- 15** 608315 60 11/16" wide x 30 1/4" tall
Discount Price - \$268.75 /Regular Price - \$403.25
Produced on 1/8" Thick White Foamacell
- 22** 608322 156 1/4" wide x 12" tall
Discount Price - \$272.25 /Regular Price - \$408.75
Produced on 3/16" Thick White Foamcore



Booth Rendering

All Prices listed above are Per Panel.

Please note that pricing listed is for Graphic Panels only. GEM units are rented separately.

GES requires a form of payment for booth graphics in order to produce signage. Please see Payment and Credit Card Authorization (G-2) for required information.

Please contact GES National Service Center at 800-475-2098 or 702-515-5970 with any questions or concerns.

Link: <https://e.ges.com/011601558/exhibit5/esm>

Please note that although arm lights may be included in your package, electrical power must be ordered separately through the electrical services provider in your exhibitor service manual. Colors may vary due to facility lighting, printing limitations and dye lot differences.

Exhibit Systems Order Form

All orders are governed by the GES Payment Policy and GES Terms & Conditions of Contract as specified in this Exhibitor Services Manual.

Affiliate Summit West
Paris Las Vegas
January 7 - 9, 2018

Discount Deadline Date:
December 18, 2017

Company Name _____ Email _____ Phone Number _____ Booth Number _____



Easy Ordering Tips:

- All prices include delivery, rental, and removal.
- Return your orders three (3) weeks before show move-in to ensure availability. At show site some items may not be available and substitutions might be necessary.
- Arm lights and shelves cannot be placed on pipe and drape.

13 oz. Carpet Color Options
(Gray will be provided if no color is indicated below)

(41) (42) (56) (40) (45) (52) (49)

Exhibit Panel Color Options
(Gray Fabric Panel will be provided if no color is indicated below)

(C41) (C50) (C79) (F41) (F40)

C Color Codes are Coated Panels
F Color Codes are Fabric

Trim Color Options
(Silver will be provided if no color is indicated below)

(41) (79)

Standard Exhibits

10x10 Exhibits

Item Code	Description	Discount (\$)	Regular (\$)	Qty	Total
600002	Exhibit System GEM #2, 10'x10' Inline	2,371.00	3,562.25		\$
	↳ Carpet Color Code: _____ Trim Color: _____ Panel Color: _____				
600003	Exhibit System GEM #3, 10'x10' Inline	4,480.25	6,720.25		\$
	↳ Carpet Color Code: _____ Trim Color: _____ Panel Color: _____				

10x20 Exhibits

Item Code	Description	Discount (\$)	Regular (\$)	Qty	Total
600004	Exhibit System GEM #4, 10'x20' Inline	9,856.25	14,784.50		\$
	↳ Carpet Color Code: _____ Trim Color: _____ Panel Color: _____				

20x20 Exhibits

Item Code	Description	Discount (\$)	Regular (\$)	Qty	Total
600005	Exhibit System GEM #5, 20'x20' Island	14,653.25	21,985.50		\$
	↳ Carpet Color Code: _____ Trim Color: _____ Panel Color: _____				

Accessories

Item Code	Description	Discount (\$)	Regular (\$)	Qty	Total
600410	Exhibit, Ad Board, 1M x 8'	774.75	1,158.25		\$
600110	Exhibit, Armlight Black	114.75	172.75		\$
600103	Exhibit, Counter, 1M Curved	1,071.00	1,606.25		\$
	↳ Trim Color: _____ Panel Color: _____				
600101	Exhibit, Counter, 1M x 1/2M x 40"H	542.00	813.00		\$
	↳ Trim Color: _____ Panel Color: _____				
600102	Exhibit, Counter, 2M x 1/2M x 40"H	741.75	1,114.50		\$
	↳ Trim Color: _____ Panel Color: _____				
600221	Exhibit, Light Box, Large 37"x85"	984.50	1,475.25		\$
600222	Exhibit, Light Box, Medium 37"x56"	778.00	1,169.00		\$
600223	Exhibit, Light Box, Small 37"x28"	479.75	720.00		\$
661931	Exhibit, Panel, Slatwall, 1M x 8'	677.50	1,016.25		\$
600291	Exhibit, Panel, Wirewall, 1M	664.25	996.50		\$

091417 011601558
D-1 062917



Exhibit Systems Order Form

All orders are governed by the GES Payment Policy and GES Terms & Conditions of Contract as specified in this Exhibitor Services Manual.

Discount Deadline Date:
December 18, 2017

Company Name _____ Email _____ Phone Number _____ Booth Number _____

Accessories

600243	Exhibit, Shelf, 1M x 10" Deep	89.50	134.50		\$
600262	Tackboard, Gem, 4' X 8'	774.75	1,158.25		\$

Electrical or Utilities Under Carpet?

Yes No

Total and Sign: Return to Fax: (866) 329-1437 • International Fax: (702) 263-1520

Please Sign →

X _____
Authorized Signature

Authorized Name - Please Print Date

I agree in placing this order that I have accepted GES Payment Policy and GES Terms & Conditions of Contract, including authorization for GES to retain personal information to better serve my need for GES services at future events.

Total Payment Enclosed →

\$ _____

Cancellation Policy: Items cancelled will be charged **50%** of original price after move-in begins and **100%** of original price after installation.

091417 011601558

D-1 062917

